

**APPENDIX A – Certificate of Title**



**COMPUTER FREEHOLD REGISTER  
UNDER LAND TRANSFER ACT 1952**



**Guaranteed Search Copy issued under Section 172A  
of the Land Transfer Act 1952**

  
R. W. Muir  
Registrar-General  
of Land

**Identifier** **188076**  
**Land Registration District** **Southland**  
**Date Issued** 17 June 2005

**Prior References**

15881 SL11C/114 SL144/216  
SL98/103

---

**Estate** Fee Simple  
**Area** 37.8725 hectares more or less  
**Legal Description** Lot 1 Deposited Plan 345887 and Lot 1  
Deposited Plan 14304

**Proprietors**

Eastern Southland YFC Southern Field Days Incorporated

**Interests**

Subject to a right of way over part lot 1 DP 345887 marked A DP 345887 created by Transfer 258754.5 - 30.6.1998 at 12:15 pm

Appurtenant to lot 1 DP 14304 is a right of way created by Transfer 258754.5 - 30.6.1998 at 12:15 pm

Subject to Section 241(2) Resource Management Act 1991 (affects DP 345887 )

6462556.5 Mortgage to (now) Westpac New Zealand Limited - 17.6.2005 at 9:00 am

9569411.1 Variation of Mortgage 6462556.5 - 10.12.2013 at 1:28 pm

Title Diagram Diagram

Cpy - 01/01, Pgs - 001, 17/06/05, 13:57



DocID: 110633873

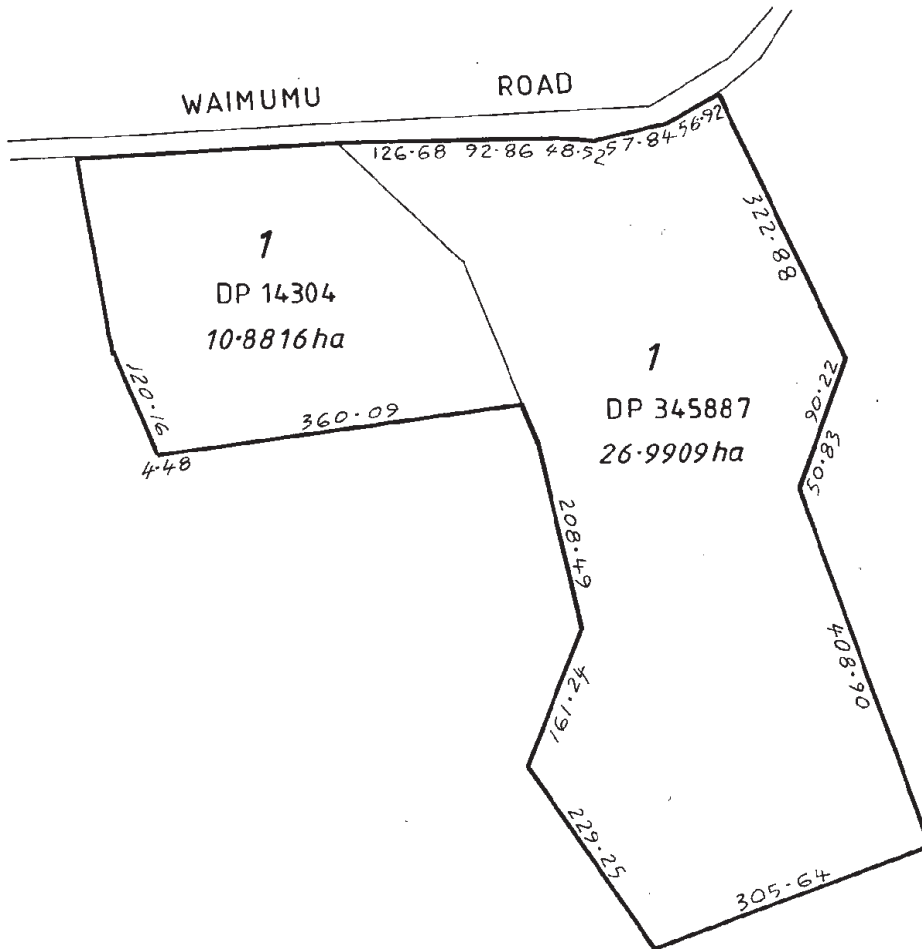

TOTAL AREA: 37.8725 ha



# COMPUTER FREEHOLD REGISTER UNDER LAND TRANSFER ACT 1952



**Guaranteed Search Copy issued under Section 172A  
of the Land Transfer Act 1952**

  
R. W. Muir  
Registrar-General  
of Land

**Identifier** 301075  
**Land Registration District** Southland  
**Date Issued** 05 February 2007

## Prior References

15880 188077

---

**Estate** Fee Simple  
**Area** 22.3138 hectares more or less  
**Legal Description** Lot 2 Deposited Plan 374657 and Lot 1  
Deposited Plan 305267

## Proprietors

Eastern Southland YFC Southern Field Days Incorporated

---

## Interests

Subject to Section 241(2) Resource Management Act 1991 (affects DP 374657)

Subject to a right to convey electricity over part Lot 2 marked A, a right to take water over part Lot 2 marked B and a right to convey water over part Lot 2 marked C on DP 374657 created by Easement Instrument 7219125.10 - 5.2.2007 at 9:00 am

Appurtenant hereto are rights to convey water and store water created by Easement Instrument 7219125.10 - 5.2.2007 at 9:00 am

7788901.1 Forestry Right pursuant to the Forestry Rights Registration Act 1983 to New Zealand Farm Forestry Association (Incorporated) Term commencing on 1.4.2003 and terminating on 31.3.2043 - 18.4.2008 at 9:00 am (Right of Renewal) (Affects Lot 1 DP 305267)

7797647.3 Mortgage to Westpac New Zealand Limited - 1.5.2008 at 9:24 am

**Title Diagram 30107!**

Cpy - 01/01\_Pgs - 001.28/02/07.09



Ducit 11C83300

